

Series 2100GL Gridlock Glass Snap-In Glass Block Window System

EXTECH
EXTERIOR TECHNOLOGIES, INC.
Creative Design & Manufacturing

You Imagine, We Deliver

Series #2100GL: Factory-assembled framing and field snap-in 2" thick glass blocks. Suitable for retrofit as well as new construction projects.

FEATURES:

- Pre-assembled aluminum framing for easier handling and installation.
- 2" thick glass blocks quickly snap into the self-locking frame without special tools, mortar, or sealants.
- 8" x 8" (nominal) solid glass blocks are practically unbreakable with superior graffiti resistance.
- No exposed fasteners.
- If damaged, blocks easily replaced without special tools or skills.
- Unlike mortar systems, fully gasketed joints will not effloresce, deteriorate, collect dirt or discolor.
- Framing available in a wide variety of finishes.
- The clarity and durability of GridLock makes the system an excellent choice for use in transit shelters.
- Creative opportunities with etched glass blocks and alternate framing patterns.
- No exposed ledges to accumulate dirt and debris.
- System backed by EXTECH's more than 35 years of experience.

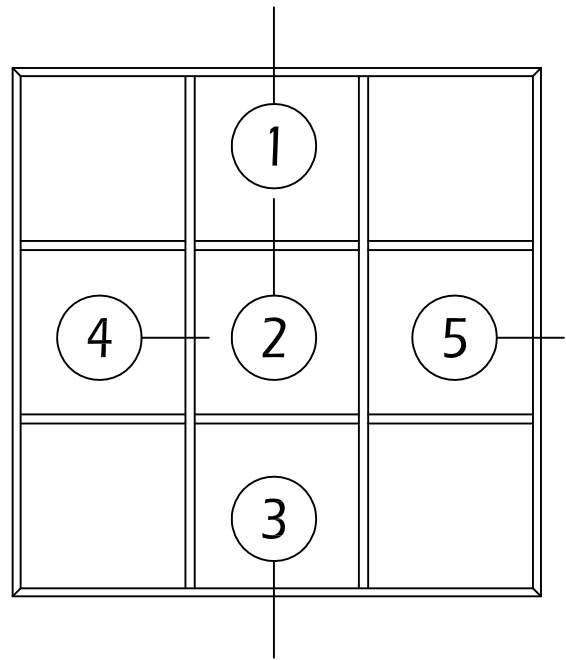

SERIES 2100GL ■ PAGE A

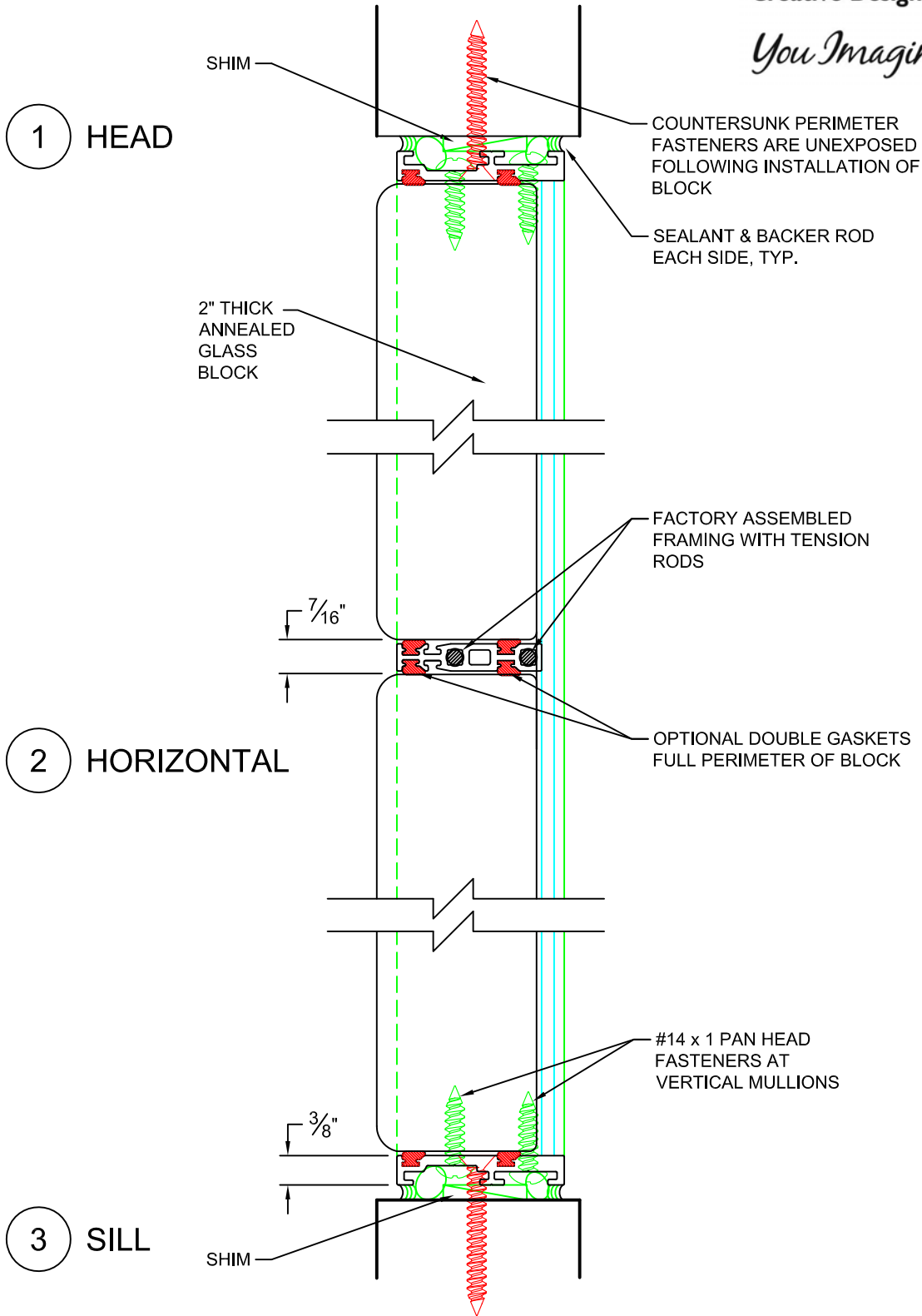

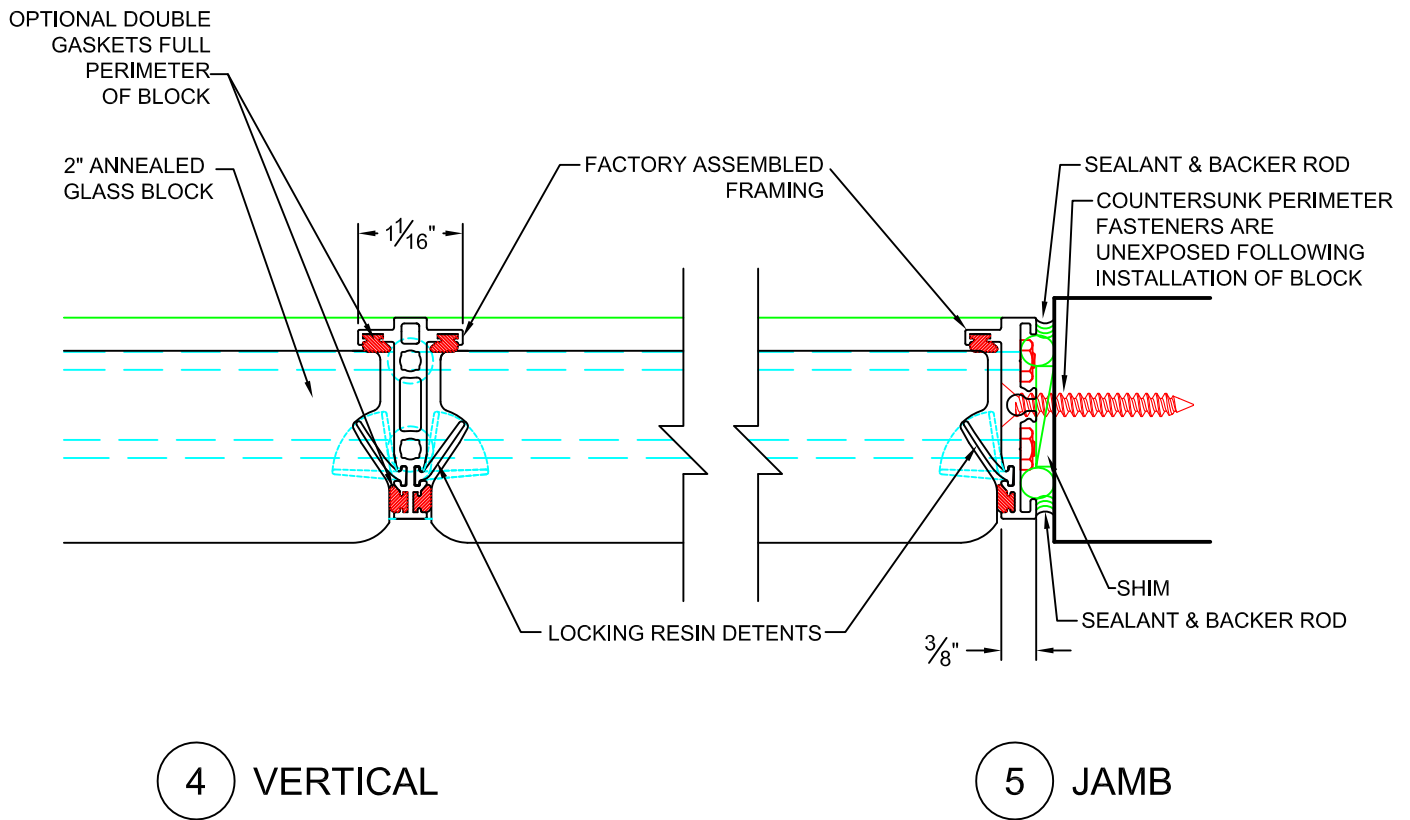

Optional Framing Patterns

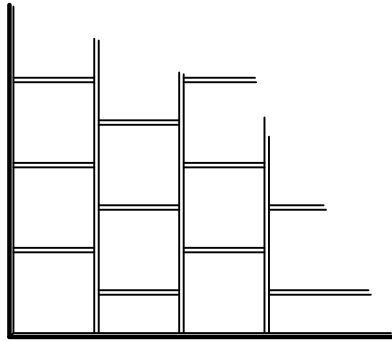

A

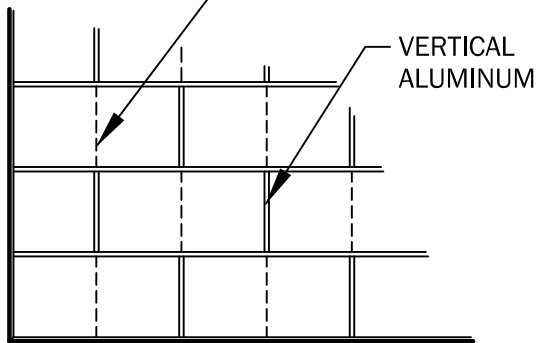

B

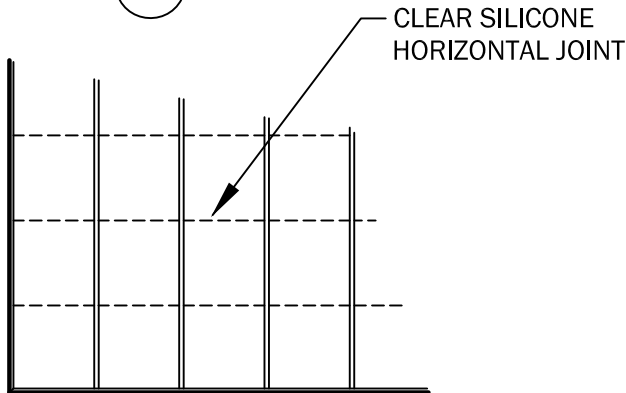

C

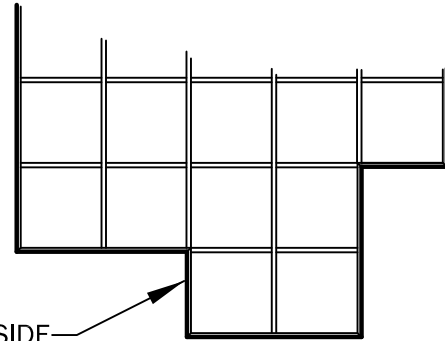

D

UNIQUE OUTSIDE PERIMETER FRAME PATTERNS

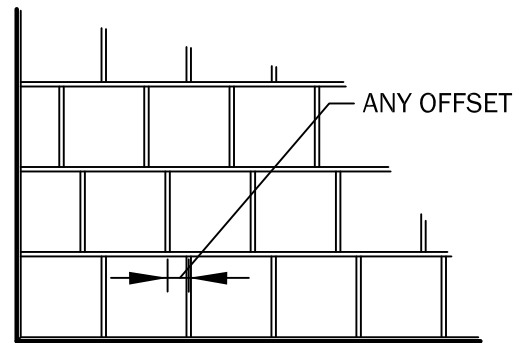

E

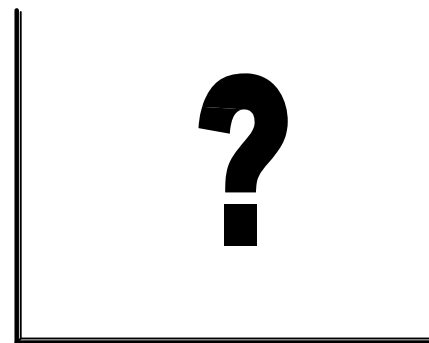

YOUR IMAGINATION